



Homes4Life Final conference_ January 28th, 2021_ Virtual

This project has received funding from the Horizon
2020 Programme under Grant Agreement n°826295



HOMES4LIFE

Certification for Ageing in Place

AWARD CEREMONY



- Introductory speech
- Pilot sites and awards
- Next steps

INTRO





THE CHALLENGE OF HOMES4LIFE

The main challenge was to assess correctly in a certification scheme the aspects of social relations and personal relations in housing

- Inventory of scientific publications, good practices, methods, existing certifications
- List of all the existing KPIs
- Translation of these KPIs into requirements or surveys' questions
- More weight in the social, personal, and economic aspects than in physical characteristics and location of the building
- Addition of residents' surveys



H4L CS: STRUCTURE AND SCORING SYSTEM

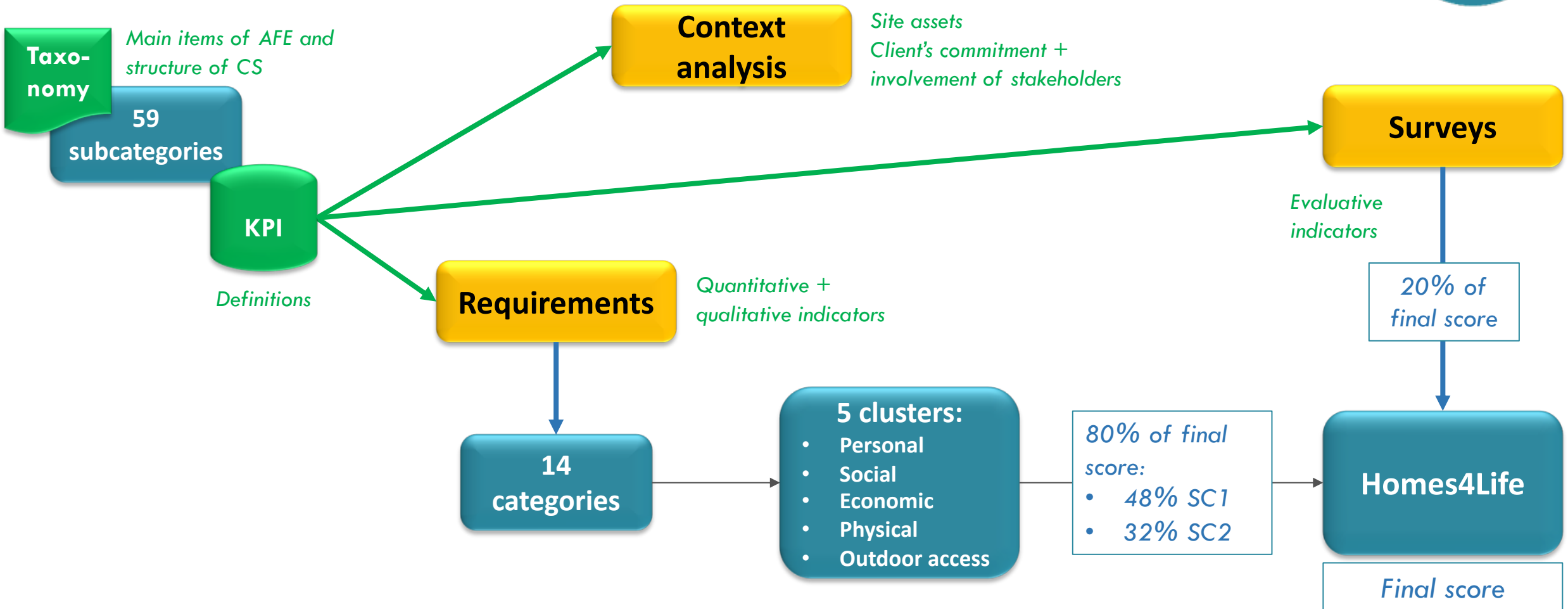

PILOT SITES & AWARDS



H4L CS: CERTIFICATION AND AWARD



Occupancy
situation



Not yet in use



In use

Life-cycle
phases

In design



Under
construction



Delivery

In operation



H4L CS: VALIDATION PROCESS BY PILOT SITES

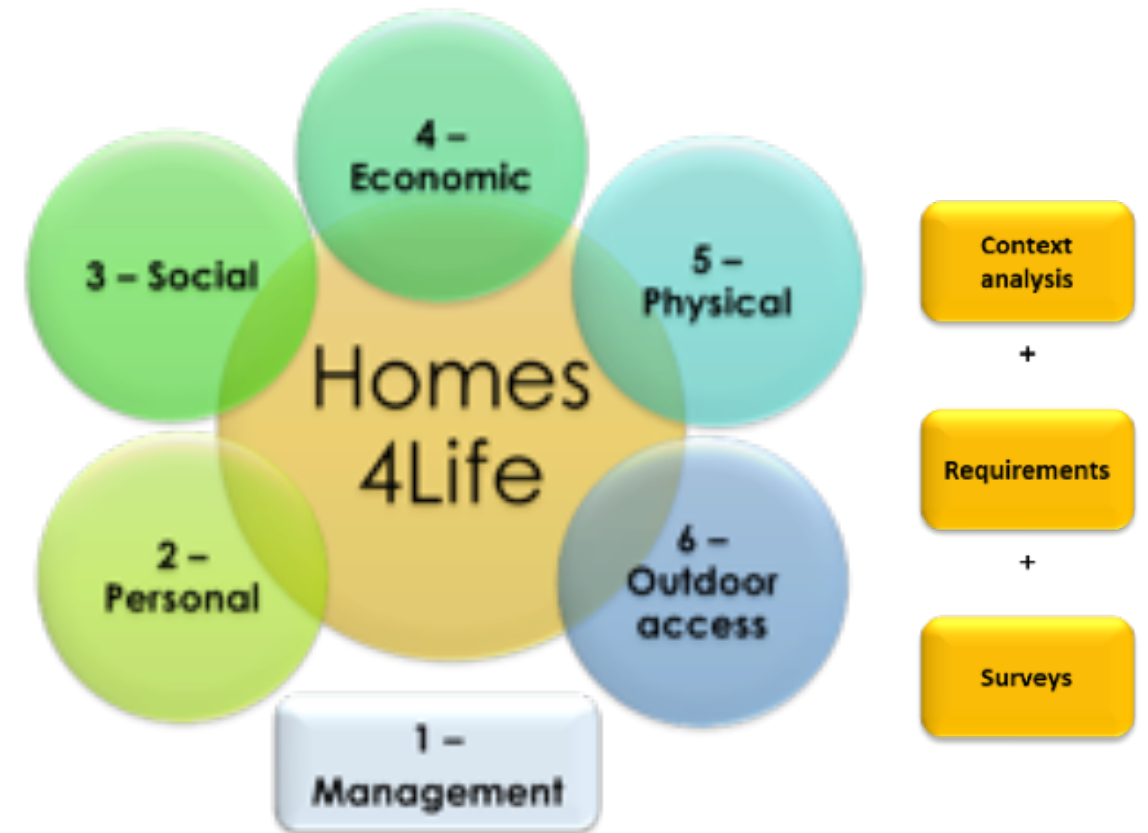
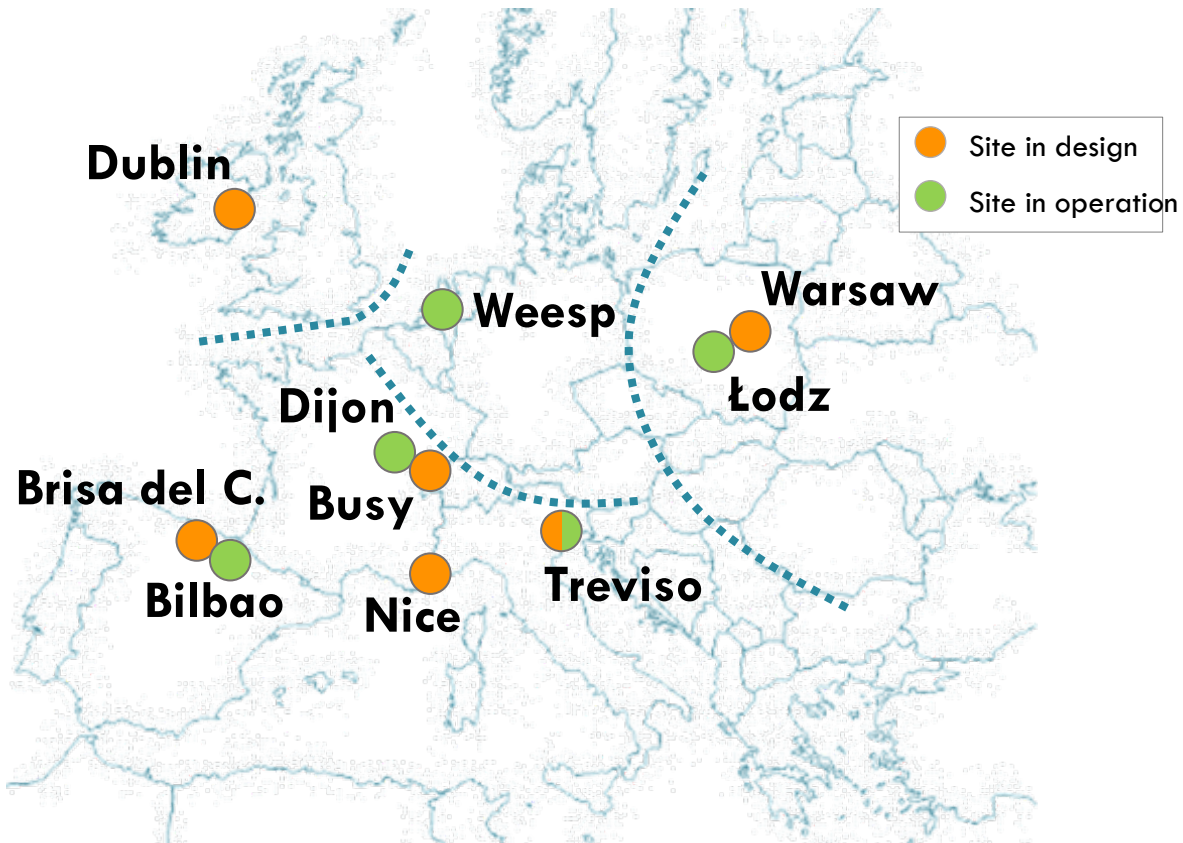

DUBLIN — ST MICHAEL 'S INCHICORE



Ciaran O'Brien, MRIAI, Director
and founding member

O'BFA
ARCHITECTS

OBFA Architects Ltd.
1 Johnson Place,
Dublin 2
D02 HW58

c.obrien@obfa.ie
+353(1)6854586

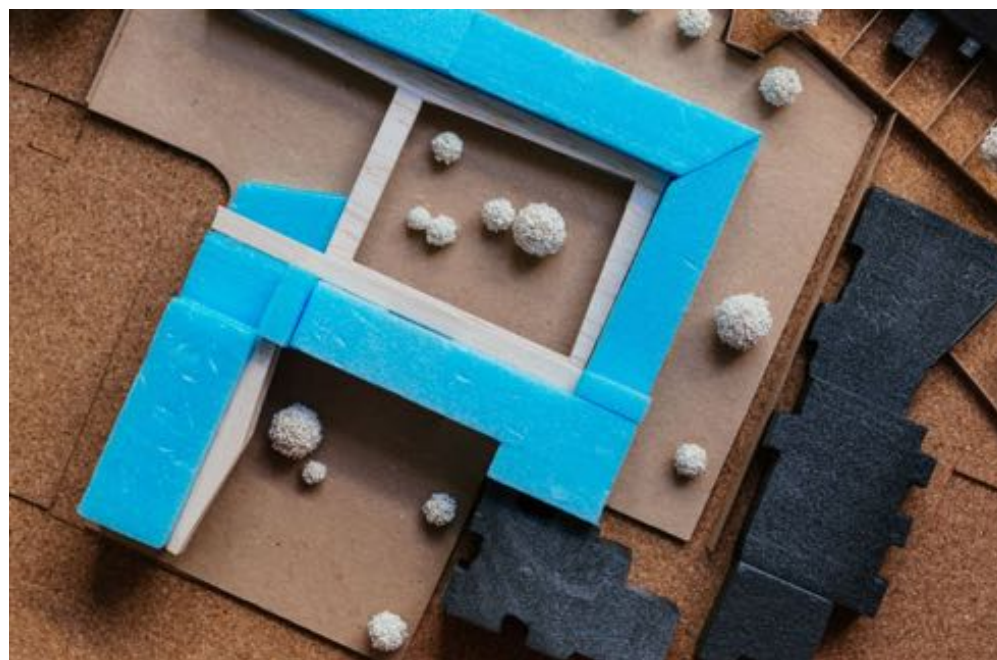

HOUSING WITH SUPPORTS/INCHICORE/DUBLIN, IRELAND



O'BF_A
ARCHITECTS



An Roinn Sláinte
Department of Health



An Roinn Tithíochta,
Pleanála agus Rialtais Áitiúil
Department of Housing,
Planning and Local Government



WHAT MAKES OUR SITE SPECIAL?



This project is a demonstrator project and is based on design principals which can be replicated at a variety of scales.

The project will inform wider policy decisions relating to older person care and their short- and long-term viability.



WHAT MAKES OUR SITE SPECIAL?



1. Adaptable typologies.
2. Flexible Block Arrangements.
3. Clear grading of open spaces.
4. Resident first design.
5. Not allowing vulnerability to meet vulnerability.
6. Establishment of a Pattern Book as guidance.
7. Extensive public consultation.



WHAT HAVE YOU LEARNED AFTER TESTING THE HOMES4LIFE CERTIFICATE?



1. Collaboration of multiple agencies is possible and desirable.
2. A high-level steering group is beneficial including detached, informed third parties.
3. The project has validated a collegiate way of working with policy makers.
4. The Co-Design process is highly valuable and will inform following projects.



WHAT HAVE YOU LEARNED AFTER TESTING THE HOMES4LIFE CERTIFICATE?



5. The regeneration and repurposing of historic buildings in established communities for this type of housing might be considered.
6. Appreciation of the life experience of older persons informs the design.
7. Some design principals can be integrated into all housing projects by default without material cost.

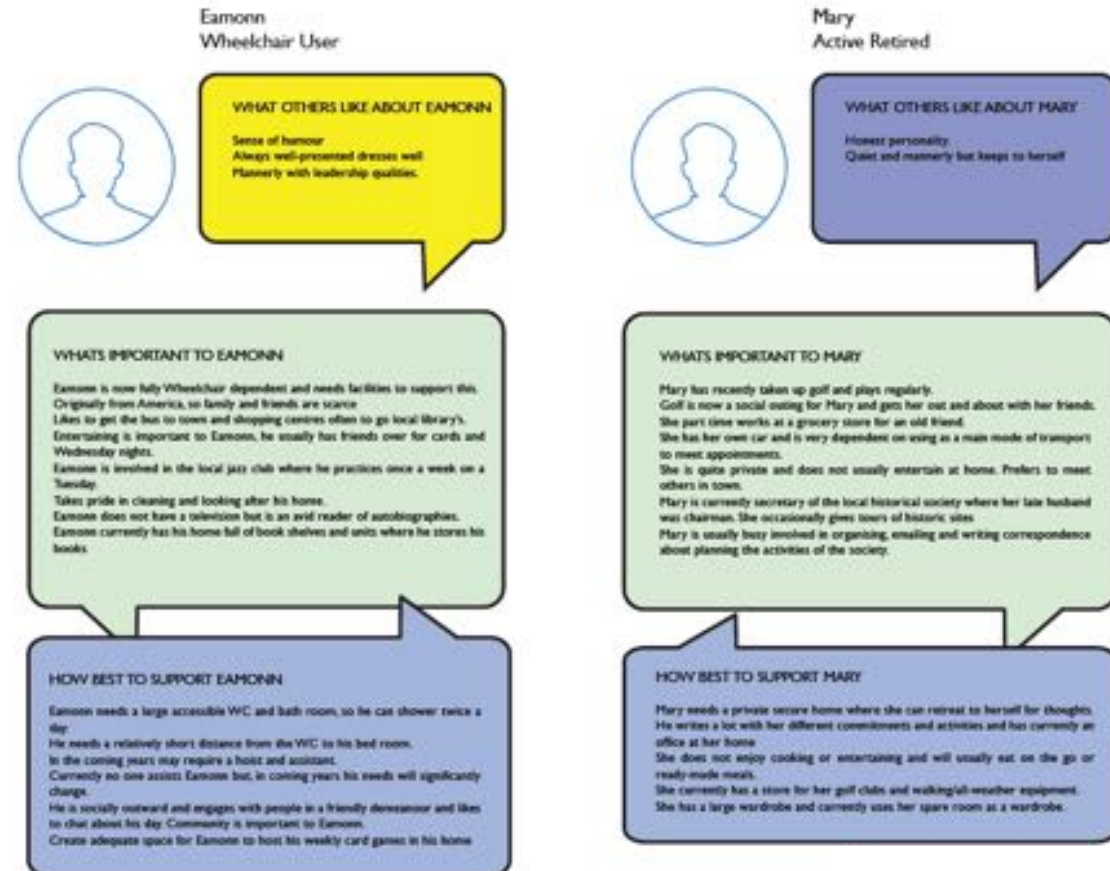

TELL US MORE



The site of Inchicore Housing in St Michael's estate was still in the design phase when you tested H4L CS.

Did testing the certificate make you rethink certain spaces or features of the project or, at least, help modify your approach to an AFE?



NICE — PÔLE INTERGÉNÉRATIONNEL MÉRIDIA



Camille Torrenti, EU Project Officer, Métropole Nice Côte d'Azur

camille.torrenti@nicedotedazur.org

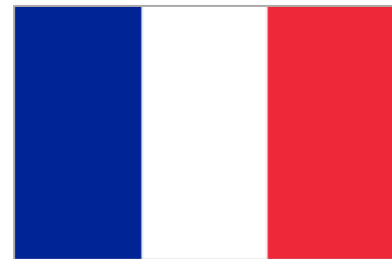

PÔLE INTERGÉNÉRATIONNEL DE NICE MÉRIDIA, FRANCE



C.C.A.S
VILLE DE NICE

Intergenerational center Nice Méridia, 13 532 sqm, not in use yet



- In the heart of Méridia, newest **sustainable eco-district** west of Nice / French Riviera
- An **urban technopolis** which places research and development at the heart of its urban area.
- A coherent **intergenerational facility** combining structures for early childhood, school classes and accommodation for **older people**
- A high ambition level in terms of **innovation and services**
- A contemporary architecture

FIVE MAIN PILLARS OF NICE MERIDIA INTERGENERATIONAL CENTER



PHYSICAL

- Innovative technologies to enhance **personal safety and health monitoring**

ECONOMIC

- Holistic environmental efficiency and sustainability approach

PERSONAL

- Opportunities for **personalisation** of spaces and for **social gathering**

SOCIAL

- Shared areas and spaces will allow **all generations to live and spend time together**

OUTDOOR ACCESS

- **Urban technopolis** combining specific advantages of a science park with benefits of a dense urban location
- **Easy connection** to the immediate environment and neighbourhood thanks to the tramway line



WHAT WE GAINED FROM HOMES4LIFE



Tests were conducted in the housing complex for autonomous elderly people (Résidence Autonomie) for 44 people and on the Nursing Home (EHPAD) for 125 people.

- Benchmark OTHER EXAMPLES OF SIMILAR PROGRAMS DEVELOPPED IN EUROPE
- SHARE BEST PRACTICES WITH OTHER CITIES AND PARTNERS IN EUROPE
- Gain recognition AT THE EUROPEAN LEVEL FOR A SUSTAINABLE intergenerational facility program PROVIDING HIGH LEVEL OF innovation and services
- Use the certification scheme DEVELOPPED by the HOMES4LIFE Project as a MODEL FOR OUR FUTURE URBAN DEVELOPPEMENT PROGRAMMES



TELL US MORE



The Nice Méridia eco-district has a strong urban ambition for the city of the future.

What were your main interests and expectations when you decided to participate as a pilot in Homes4Life to test the certification?



Nice

BUSY — RÉSIDENCE KALIA



Martial Vuillemin, Co-manager, Innovation Director

mail: martial.vuillemin@a2seniors.fr

web: <https://www.a2seniors.fr>



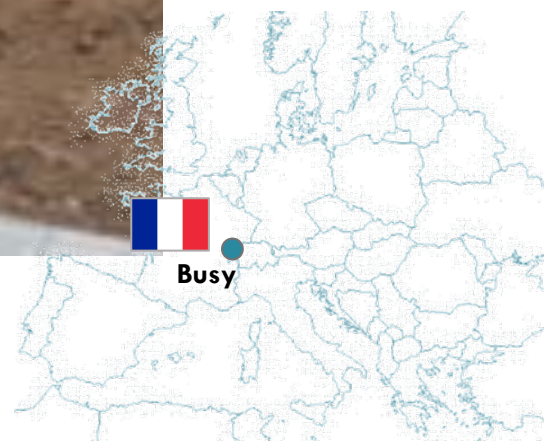

NEUILLY-LÈS-DIJON — ALICE & VICTOR



François Scherer, Manager

mail: lcsv@orange.fr

web: <https://www.alice-et-victor.fr/>





TREVISO — BORGO MAZZINI SMART COHOUSING



Dr. Oscar Zanutto, Chief of European Projects Department at ISRAA, Treviso

e-mail: faber@israa.it

web site: www.fabbricaeuropa.eu



ISRAA

Istituto per Servizi di Ricovero
e Assistenza agli Anziani



BORGO MAZZINI SMART COHOUSING TREVISO, ITALY



WHAT MAKES OUR SITE SPECIAL?



- Refurbishment of historical (public) buildings otherwise in disuse
- Co-created Model
- Central position of the site (no need for a car to reach main facilities)
- Accessibility and for all by design
- Availability of services (bus stops, healthcare, shops, groceries, etc.)
- Value proposition of housing model (social engagement, health support, ...)

WHAT HAVE YOU LEARNED AFTER TESTING THE HOMES4LIFE CERTIFICATE?



- **Co-creation as a value for the model**
- Underlined the importance of **social and community spaces**
- **Confirmed that the model adopted for the first part of site [in use] has value and is worth replicating in the second part [in development]**
- New insights on **the importance of urban spaces and surroundings in the value of a residential building and impact on the possibility to age in place**

TELL US MORE



You have tested H4L at different construction stages, i.e. in buildings both in design and in operation.

How do you think Homes4Life can continue supporting you in your housing life-course approach?



WARSAW — MIMO WIEKU



Jan and Agnieszka Ciesla, architects and founders of Fundacja Mimo Wiek

mail: jan.ciesla@mimowiek.pl & agnieszka.ciesla@mimowiek.pl

web: <http://mimowiek.pl/>



U SIEBIE MIMO WIEKU





ŁÓDŹ — MULTIGENERATIONAL HOUSE



Joanna Brzezińska - Deputy Director Revitalisation and Housing Bureau, City of Lodz

Anna Kobalczyk - Project Officer Revitalisation and Housing Bureau, City of Lodz

Revitalization and Housing Bureau

City of Lodz

Piotrkowska 171 street

90-477 Lodz, Poland

E-mail: brim@um.lodz.pl



MULTI-GENERATIONAL HOUSE, LODZ/POLAND



Photo of the housing community at the opening ceremony with the Mayor of Lodz, August 2019





WHAT MAKES OUR SITE SPECIAL?

- New way of occupying municipal town houses.
- Social mix – ensuring equal proportions of tenants from different age and social groups as well as level of independence, that is: young people (leaving foster care), families with children, older people and people with disabilities.
- Providing proper housing conditions for older and dependent people (to prevent social exclusion).
- Creating an open, tolerant community, in which unrelated people help each other.
- Common space „Neighbourgood Club” designed for all residents (a place which helps to build the potential of a local community).

WHAT HAVE YOU LEARNED AFTER TESTING THE HOMES4LIFE CERTIFICATE?



- The Homes4Life certificate made us aware of the importance of good integration between social, physical and economic aspects of senior citizens' housing.
- Detailed analysis of the site and its socio-spacial context helped us to understand better that the building's layout, its configuration and neighbourgood have an impact on the quality of life of residents.
- Survey with residents helped us to assess the level of their satisfaction with living in their new flats and in a community of the Multi-generational House. It's a good tool for evaluation in future projects.

TELL US MORE



The multi-generational house is part of a large-scale operation which aims at revitalising a former industrial district of Lodz hit by an eco-industrial crisis.

Has your experience with H4L changed the way you look on how to bring back inhabitants in these neighbourhoods and make different generations live together?

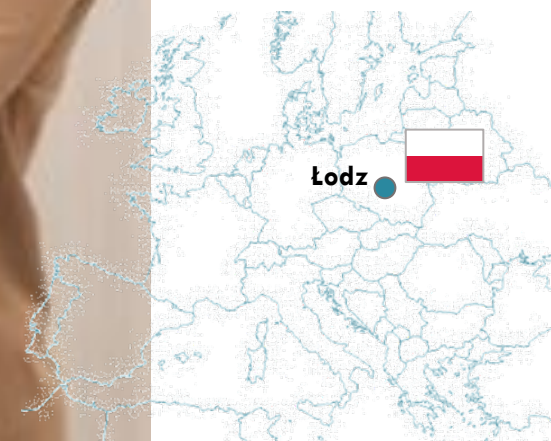

BRISA DEL CANTABRICO — CIUDAD RESIDENCIAL



Nemesio Rasillo Oliver , Founder Sociedad Cooperativa Ciudad residencial Brisa del Cantábrico

web: <https://brisadelcantabrico.com/>





BILBAO — ETXEGOKI



Sergio Murillo Corzo, Minister for Social Action, Government of Biscay

GOVERNMENT OF BISCAY

Sergio Murillo Corzo
Minister for Social Action
sergio.murillo@bizkaia.eus

ETXEGOKI

Garat Txomin Avenue, 46
ES48004 Bilbao, Biscay



ETXEGOKI [ADAPTED HOME, IN BASQUE]

BILBAO, BISCAY, BASQUE COUNTRY





WHAT MAKES OUR SITE SPECIAL?

- A building.
- 32 supported apartments.
- For people with physical disabilities.
- Owned by Government of Biscay.
- Managed by FEKOOR – Physical Disability Associations Federation in Biscay.
- Started in 2011.
- Part of the community.
- A neighbourhood of 32 people.
- Where life projects take place.
- With technological and human support.
- Guaranteed by the Government of Biscay and FEKOOR.
- Evolving since 2011.

WHAT HAVE YOU LEARNED AFTER TESTING THE HOMES4LIFE CERTIFICATE?



- Transforming the environment, beyond the building, from a “home4life”.
- Reference need to be able to communicate with technical side (architects, engineers...).
- Considering the evolving reality of users needs, and empowering process.
- Something to share:
 - A nice example is important.
 - Scaling tools necessary.
 - Change of approach compulsory.

TELL US MORE



Your objective is to enable adults with severe physical disabilities to live as independently as possible in their own apartment, sometimes with the help of digital techniques.

After ten years of opening and a large experience, what is the added value that Homes4life can bring to you?



WEESP — DE HOGEWEEK



Eloy van Hal and Jannette Spiering, Senior advisors at Be Advice, founders of The Hogeweyk®



eloy@bethecareconcept.com

jannette@bethecareconcept.com

info@bethecareconcept.com



The Hogeweyk® A neighborhood for people living with severe dementia



Jannette Spiering
Senior Advisor Be Advice
Founder of The Hogeweyk®
jannette@bethecareconcept.com
+31 6 2224 1912

Eloy van Hal MSc
Senior Advisor Be Advice
Founder of The Hogeweyk®
eloy@bethecareconcept.com
+31 6 5163 4134

www.bethecareconcept.com

The Hogeweyk® Heemraadweg 1 1382 GV Weesp The Netherlands +31 294 210 500 part of the Vivium care group



DISRUPTING TRADITIONAL NURSING HOME CARE

From the old nursing home Hogeweyk



1970

To a neighbourhood, a community The Hogeweyk®



2009

The Hogeweyk Care concept

- is a culture change in care for people living with severe dementia
- emancipates people living with dementia
- focusses on experiencing health and quality of life
- continuously supported by the best healthcare professionals
- creates a lively community to meet and participate, live (safe) and foster autonomy and independency
- enables residents to stay part of society

Guiding principles to RE-HUMANISE

- 1 De - institutionalise
- 2 Transform
- 3 Normalise

The social-relational model replaces the medical model



HOMES4LIFE CERTIFICATION FOR AGEING IN PLACE

- Homes4Life certification validates that The Hogeweyk, developed in the period 2002 – 2010, is meeting the high standards
- Homes4Life validates our development model, the Be Advice Paradigm®



TEAM *BE ADVICE*



Eloy van Hal MSc
Senior Advisor Be Advice
Founder of The Hogeweyk®
eloy@bethecareconcept.com
+31 294 210 500
+31 6 5163 4134



Jannette Spiering
Senior Advisor Be Advice
Founder of The Hogeweyk®
jannette@bethecareconcept.com
+31 294 210 500
+31 6 2224 1912



Iris van Slooten
Advisor Be Advice
iris@bethecareconcept.com
+31 294 210 500
+31 6 5705 8897



Yvonne van Amerongen
Former Senior Advisor Be Advice
Founder of The Hogeweyk®
Retired but still committed
+31 294 210 500



Be holds office at:
The Hogeweyk®
Heemraadweg 1
1382 GV Weesp
The Netherlands

info@bethecareconcept.com



www.bethecareconcept.com

TELL US MORE



You have already received numerous awards and your site is recognised for its attention to people with severe dementia.

Rather than considering what H4L could do for you, I would like to ask you what – from your experience – you can bring to H4L that is useful to build an AFE?



NEXT STEPS





FURTHER IMPROVEMENTS

Some main further improvements have been identified:

- Earlier phase of assessment (Planned)
- Optimize requirements in clusters and questions in surveys
- Test and maybe adapt certification process for sites with long commitments
- Contextualize management for some countries
- ...

→ A certification scheme is a living system

EXPLOITATION STRATEGY

Management of the H4L CS

Up-to-date certification
Market watch services

Royalties (€)

**Marketing & Selling of the
H4L CS**

Service contracts (€)

**H4L
Training**

**H4L
Assessments**



UNIVERSITÀ
POLITECNICA
DELLE MARCHE





www.homes4life.eu



@Homes4LifeH2020

QUESTION & ANSWER

WHAT
DO YOU
MEAN
?



personal
connectivity
care
safety
affordability
neighbourhood
emotional
employment
capacities
smart
health
accessibility
dignity
choice
all-life-course
preferences
home
activity
comfort
social
privacy
orientation
identity
well-being
building
readiness
Homes4Life



- Do you also want your building to be recognised as age-friendly housing supporting health and well-being ?
- Do you want to invest with confidence into a certified age-friendly home ?
- Are you interested to work with us to manage and deliver the Homes4Life certification?

CERWAY
+33 140 50 28 85
cerway@cerway.com



Deliverables available on <http://www.homes4life.eu/deliverables/>
Silvia.urra@tecnalia.com

THANK YOU FOR YOUR ATTENTION!